

Sample - Works as Executed Drawing

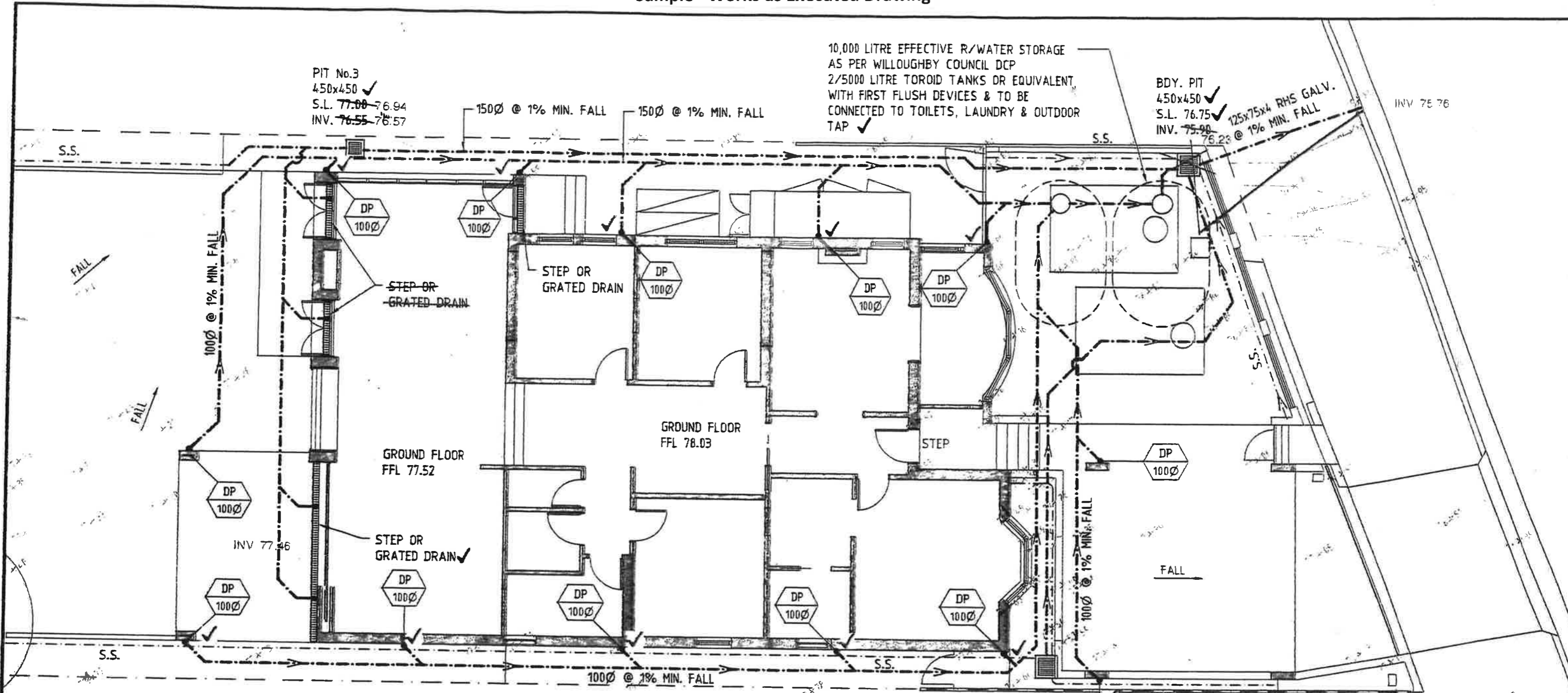

GROUND FLOOR STORMWATER DRAINAGE PLAN

SCALE 1:100

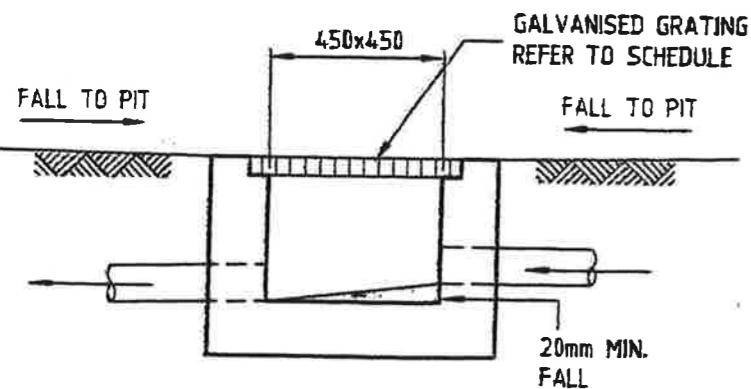

TYPICAL PIT DETAIL

NOTE: PITS DEEPER THAN 1200 TO BE 1000 x 1000 WITH STEPIRONS AS REQUIRED

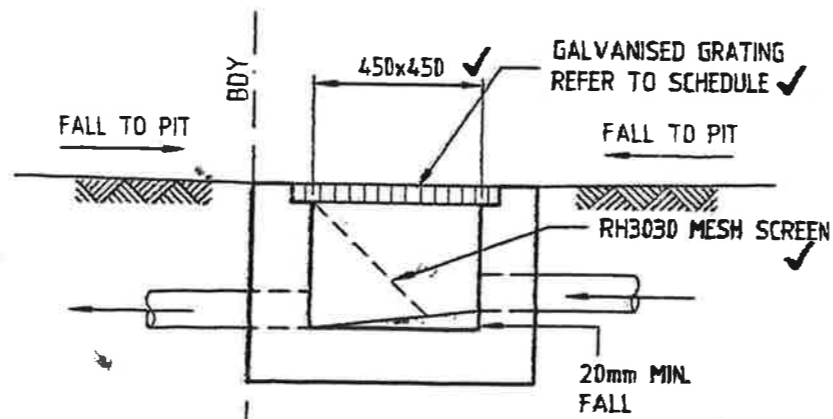

BOUNDARY PIT DETAIL

(TYPICAL)

1:20

WE HEREBY CERTIFY THAT THE WORKS HAVE BEEN CONSTRUCTED ACCORDING TO THE LEVELS SHOWN, (OR AS AMENDED IN RED HERON), THAT THE LEVELS ARE IN AGREEMENT WITH PLANS APPROVED BY COUNCIL, AND DETENTION DRAINAGE VOLUMES MEET OR EXCEED THE REQUIRED VOLUME STIPULATED ON THE APPROVED DEVELOPMENT PLANS.

27-9-18

C	MAR. '17	ISSUE FOR CONSTRUCTION CERTIFICATE
B	NOV. '16	MINOR REVISIONS
A	OCT. '16	ISSUE FOR APPROVAL
No.	Date	Revision

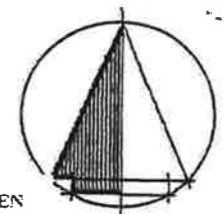

Consulting Structural & Civil Engineers

Architect: [REDACTED]

Project: [REDACTED]

Title: GROUND FLOOR STORMWATER DRAINAGE PLAN

Date	Scale	Project Number	Revision No
OCT. '16	1:100, 1:20	2016/219-SW2	C