

Venue Snapshot

Castle Cove Community Room



| | |
|---|---|
| Special Conditions: | ✓ - Alcohol permitted with conditions |
| Room Dimensions: | 10.40mx 7.75m + 4m entry |
| Room Capacity: Theatre Layout Classroom Layout Boardroom Layout Active Class Standing N.B Please see layout diagrams next page | People 40 18 14 12 40 |

✓ = available at this venue x = not available at this venue
\$ = available for hire at this venue (fees apply)

| Amenities | Kitchen/Catering | Technology | Equipment/Furniture |
|--|-------------------------------------|---------------------------|--|
| ✓ Disabled access | x Kitchen - Full | x Audio Visual system | ✓ Tables - Full Trestle Size (4) |
| ✓ Outdoor area | ✓ Kitchenette - sink & hot water | x Amplifier | ✓ Tables - Childrens Size (2) |
| x Outdoor area - with playground equipment | x Tea/Coffee Crockery - Dry Hire | ✓ Projector - Inbuilt | ✓ Seating - Chairs - Adult size (14/26) |
| ✓ Air conditioning | x Luncheon Crockery - Dry Hire | x Projector - Portable | ✓ Seating - Chairs - Childrens Size (12) |
| ✓ Heating | x Cutlery - Limited | x Projector screen | ✓ Seating - Couch or arm chairs |
| x Ceiling Fans | x Water glasses | x Computer/PC | x Piano |
| x Electric Fans | x On site Café | x Whiteboard - Inbuilt | x Table Tennis Table |
| ✓ Parking | x On site Catering | x Whiteboard - Electronic | x Pool Table |
| ✓ Disabled parking | x Oven | x Whiteboard Portable | x Gym Equipment |
| ✓ Toilet facilities (internal) | x Stove | ✓ WiFi - Limited | x Portable partitions |
| x Toilet facilities (external) | ✓ Microwave | x Lectern | x Trolley - Upright |
| ✓ Accessible toilet | x Dishwasher | x Projector trolley | ✓ Bins |
| x Shower Facilities | ✓ Fridge - Full size | | |
| x Storage | x Fridge - Bar fridge size | | Flooring |
| x Basketball/Futsal Courts | x Hot Water - Kettle | | ✓ Flooring - Carpeted |
| x Stage | ✓ Hot Water - Zip System | | Flooring - Dance Floor |
| ✓ Powerpoints (8) | x Hot Water - Electric Urn | | Flooring - Vinyl Floor |
| | | | Flooring - Polished Timber |

Theatre Layout

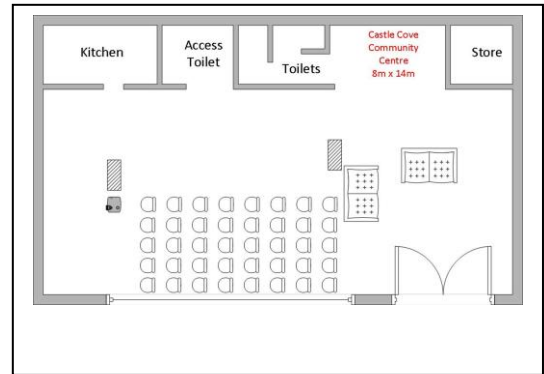

Classroom Layout

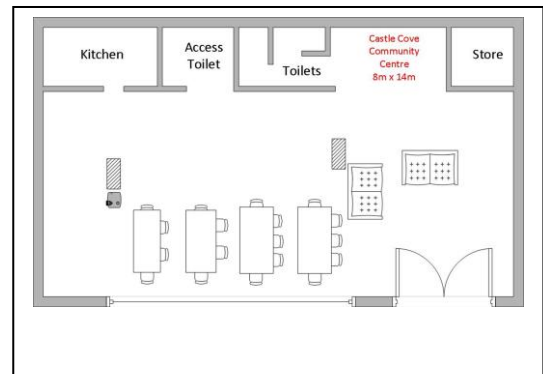

Standing/Active Layout

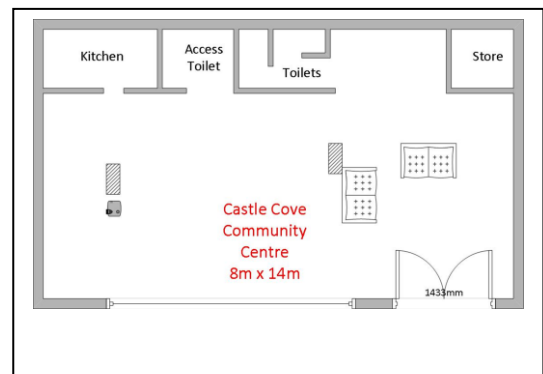

Boardroom Layout

